

## 40182: O-Bracket Ø51

Included 4 pcs self-tapping screws

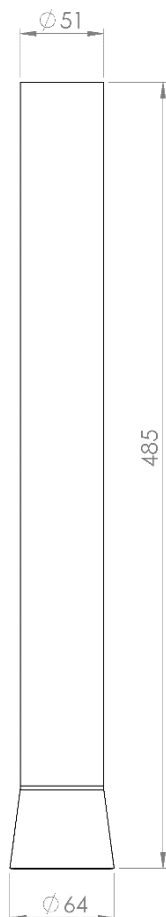

For fixation of profiles and posts.  
Extra stable for traffic sign post.

Adjustment angle: 20°  
Adjustable height: 50 mm  
Turnable: 360°

Force normal ground:  
Pressure: 20 kN (2 ton)  
Pull: 10 kN (1 ton)  
Sideways force: 7 kN (0,7 ton)  
Weight: 1,75 kg

Galvanized metal sheet: C4  
Normal life span: 95 years

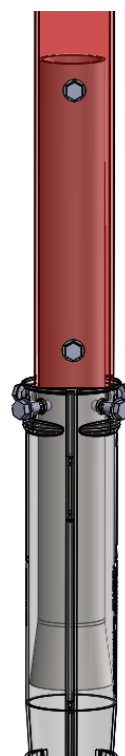

Fit square profiles, outside.

For clean look use Cover cap 40183.

Use 2 pcs screws 40150 alt. 40160.

Drill 2 pcs holes Ø7 mm in the profile.

Inside dimension: 52 – 65 mm.

